



Images shown are for illustrative purposes only and may not represent the final product such as lighting, window furnishings, timber look garage door & timber windows. Façade details including entry door and window sizing may vary between house types. Pricing also excludes features such as fencing, landscaping, letter box, decking, driveway and any notable features of the façade. Please speak with your sales consultant for further details.

FIXED PRICE HOME AND LAND

LOT 311, Wattle Grove Estate, Corio (512M2)

FLOOR PLAN: Maple 21_202
FACADE: Autumn

\$527,782

FIRST HOME OWNERS PRICE \$507,782

4 2 2 1 21sq

WELLNESS LIVES HERE
You should too.

PACKAGE INCLUSIONS:

- ▶ LIFETIME STRUCTURAL GUARANTEE
- ▶ DEVELOPER & COUNCIL REQ'S
- ▶ 450MM EAVES TO FACADE
- ▶ KEYED WINDOW LOCKS TO ALL OPENABLE WINDOWS
- ▶ 3 COAT PAINT APPLICATION
- ▶ SECTIONAL LIFT GARAGE DOOR
- ▶ TILED SHOWER BASE
- ▶ FINANCE SOLUTIONS AVAILABLE
- ▶ ... AND MUCH MORE!

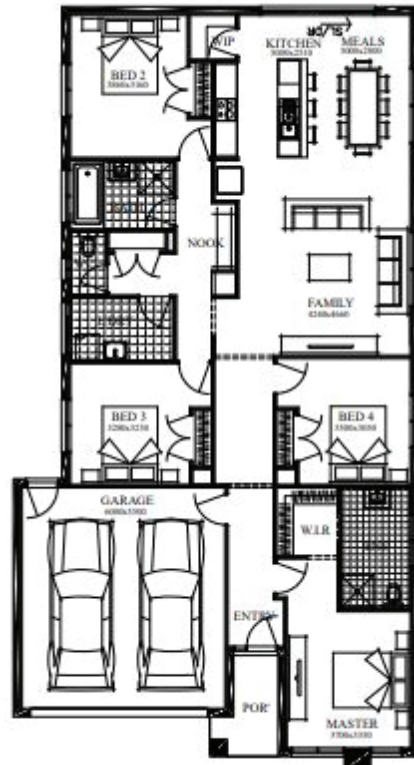

For enquiries please contact:
Bruno Esposti
0435219103
simondsxpress.com.au

GEELONG VIC 3220
Geelong
bruno.esposti@simonds.com.au

